



For more information including  
a video guide please visit:

[www.encorecistern.com](http://www.encorecistern.com) | [info@encorecistern.com](mailto:info@encorecistern.com)

For technical support call:

+44 (0) 800 032 2862



## CISTERN ASSEMBLY INSTRUCTIONS

Tools Required

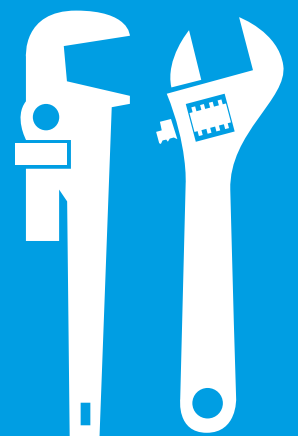





- 1** Slide the filter mesh into the filter tray.

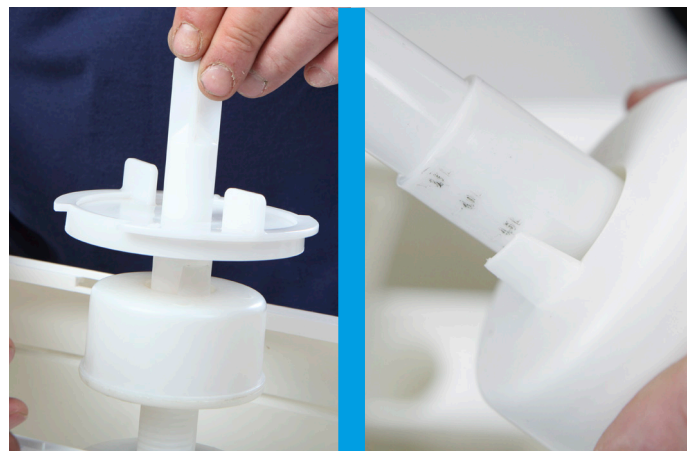

- 2** Adjust clockwise and anticlockwise to align marker tag to discharge volume.  
Supplied factory prest at 4.5 L.

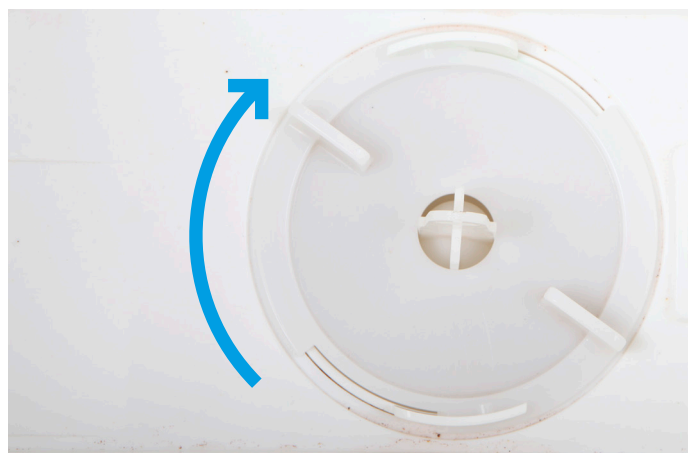

- 3** Attach leak path cap to the valve stem. Insert through the divider plate and twist to lock in position.



- 4** Attach the pull strap to the top of the valve stem and the actuator body.



- 5** Ensure that the float valve is correctly assembled and the plastic tail hangs freely.



- 6** Check that the hose to the connector in the cistern lid and is secure.



- 7** Tighten all fixings.



- 8** Fit Encore brackets to the wall to suit installation location using template supplied.



- 9** Cistern fitted to customers own installation frame using Encore metal bracket option.



- 10** Connect air tube on cistern lid to single push pneumatic flush plate (supplied by installer). Compatible with infrared flush sensor. (Contact Encore for further details).



- 11** Connect mains fill valve in accordance with legal requirements.